

Digital counter for injection moulds

CVe Monitor™ BRW 841 130

The new digital counter is an electronic monitoring device developed especially for injection moulding tools.



Technical specifications:

- Maximum ambient temperature 90°C
- Water resistant to IEC protection class IP 10
- The counter is preset to -25 cycles at the time of delivery to allow for tool start-up and test mouldings to be carried out with the tool.

The following process data may be displayed at the touch of a button:

- Total number of cycles
- Cycle times, based on total tool running time
- Cycle times, determined after 25,000 production cycles
- Working time in %, based on the working life of the tool
- Working time in %, after 25,000 production cycles
- Integrated, resettable cycle counter

Special features:

- 2 GB internal memory
- Logs may be transferred to a PC via USB cable
- Free software available to download from www.brw.ch
- Upgradable; mounting dimensions compatible with cycle counter BRW 841140
- Battery operating life: min. 5 years
- Patents granted and applied for worldwide

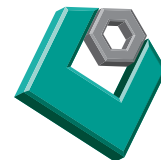

Display data



The total number of cycles is displayed.

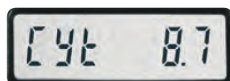

Cycle time (seconds) based on total tool running time is displayed.

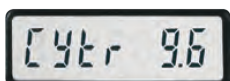

Cycle time (seconds) determined at the end of 25,000 production cycles is displayed.



The ratio of tool production time to production interruptions or downtimes is displayed as a percentage.



The ratio of tool production time to downtimes after 25,000 production cycles is displayed as a percentage.

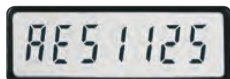

A separate cycle counter can be reset to zero in order to display a transient test of cycles in comparison with produced parts.

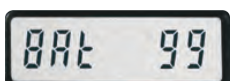

The battery charge status is displayed as a percentage. An alarm appears at 5%; monitor replacement is required at this time.



When the "Flashdr" mode is switched on, logs with tool-specific data such as parts lists, drawings and tool parameters for setting up on the machine can be produced on the computer with the aid of the USB cable.

Logging functions:

- Logs may be generated with the help of free software.
- A USB cable plus Excel 2003 or later is required for the logging software.
- The software is compatible with Windows 7, Windows XP or Vista.
- The user is first required to register, after which he is given a user name and password.
- The log provides a weekly overview of the performance of the injection moulding machine using the data recorded by the CVe Monitor™. It shows the cycle, operating and downtimes at the present moment and in comparison with earlier years, that is to say over the entire service life (min. 5 years) of a CVe Monitor™.

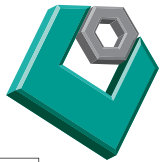

Information on the logging software, available from www.brw.ch

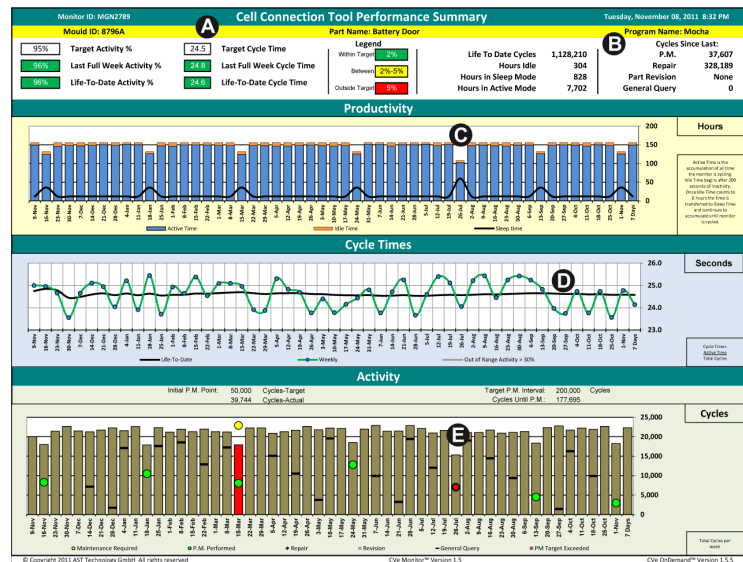

This software enables the user to call up the following data, such as drawings or tables, as PDF or Excel files and forward them to the client:

A: After activation of the software, the specified cycle times and the percentage proportion of production times in comparison with downtimes are read out.

B: A listing in tabular form shows the weekly production and downtimes.

C: The bar diagram shows the weekly production and downtimes.

D: The shape of the curve shows the weekly cycle time with the corresponding deviations from the production history.

E: This log shows the tool activity.

The planned dates for preventative maintenance are compared with the actual maintenance intervals

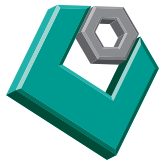

OnDemand Activity Log [Software version 1.5.5]												
Cve Initialize Date		24-Oct-10	11-Nov-10									
Device ID		MGH2789	MGH2789									
Mould #		8796A	8796A									
Part Name		Battery Door	Battery Door									
Program Name		BtoCts	BtoCts									
Customer		Cell Connection	Cell Connection									
Target Activity %		N/A	95%									
Target Cycle Time		N/A	24.5									
Initial P.M. Point		50,000	50,000									
Target P.M. Interval		200,000	200,000									
Cycles Prior to Cve Installation		0	0									
Cve Connection Reason												
Date/Time	BAT	Cycles	OD User	Conn. By	Company	Dest.	REV	INT	REP	GRV	REV	Notes
08-Nov-11 21:05	95	1,128,210	MOLDMAS1	Carol Sperow	Cellular Conn.	G	N	N	N	N	N/A	
27-Oct-11 6:51	95	1,090,603	FASTTOOL	Theo Hoyer	Cellular Conn.	Compliance@CC.com	N	Y	N	N	N/A	Cleaning and Inspection Completed
15-Oct-11 20:57	95	1,052,996	MOLDMAS1	Carol Sperow	Cellular Conn.	Compliance@CC.com	N	N	N	N	N/A	
21-Sep-11 20:55	95	977,782	MOLDMAS1	Carol Sperow	Cellular Conn.	Compliance@CC.com	N	N	N	N	N/A	
08-Sep-11 6:50	95	940,175	FASTTOOL	Theo Hoyer	Cellular Conn.	Compliance@CC.com	N	Y	N	N	N/A	Cleaning and Inspection Completed
27-Aug-11 21:05	96	902,968	MOLDMAS1	Carol Sperow	Cellular Conn.	Compliance@CC.com	N	N	N	N	N/A	
01-Aug-11 20:45	96	827,354	MOLDMAS1	Carol Sperow	Cellular Conn.	Compliance@CC.com	N	N	N	N	N/A	
23-Jul-11 7:12	96	800,021	FASTTOOL	Theo Hoyer	Cellular Conn.	Compliance@CC.com	N	Y	V	N	N/A	Cleaning, inspection and repair completed: cracked material saver replaced. Pics and work order on flasher.
23-Jul-11 21:00	96	762,414	MOLDMAS1	Carol Sperow	Cellular Conn.	Compliance@CC.com	N	N	N	N	N/A	
27-Jun-11 21:10	96	687,200	MOLDMAS1	Renee Sanchez	Cellular Conn.	Compliance@CC.com	N	N	N	N	N/A	
03-Jun-11 6:50	97	611,986	FASTTOOL	Theo Hoyer	Cellular Conn.	Compliance@CC.com	N	Y	N	N	N/A	Cleaning and Inspection Completed.
22-May-11 21:05	97	574,379	MOLDMAS1	Carol Sperow	Cellular Conn.	Compliance@CC.com	N	N	N	N	N/A	
27-Apr-11 20:58	97	499,165	MOLDMAS1	Carol Sperow	Cellular Conn.	Compliance@CC.com	N	N	N	N	N/A	
03-Apr-11 20:57	97	423,951	MOLDMAS1	Carol Sperow	Cellular Conn.	Compliance@CC.com	N	N	N	N	N/A	
13-Mar-11 6:51	98	410,000	FASTTOOL	Theo Hoyer	Cellular Conn.	Compliance@CC.com	N	Y	N	N	N/A	Cleaning and Inspection Completed
07-Mar-11 21:00	98	380,000	MOLDMAS1	Carol Sperow	Cellular Conn.	Compliance@CC.com	N	N	N	N	N/A	
07-Feb-11 21:01	98	294,786	MOLDMAS1	Carol Sperow	Cellular Conn.	Compliance@CC.com	N	N	N	N	N/A	
15-Jan-11 6:50	98	225,326	FASTTOOL	Theo Hoyer	Cellular Conn.	Compliance@CC.com	N	Y	N	N	N/A	Cleaning and Inspection Completed
03-Jan-10 20:52	98	187,719	MOLDMAS1	Renee Sanchez	Cellular Conn.	Compliance@CC.com	N	N	N	N	N/A	
09-Dec-10 21:01	99	112,505	MOLDMAS1	Carol Sperow	Cellular Conn.	Compliance@CC.com	N	N	N	N	N/A	
11-Nov-10 6:50	99	30,056	FASTTOOL	Theo Hoyer	Cellular Conn.	Compliance@CC.com	N	Y	N	N	N/A	Initial maintenance check performed. Pictures and measurements on flasher.
24-Oct-10 17:45	99	0	FASTTOOL	Theo Hoyer	Cellular Conn.	Compliance@CC.com	N	N	N	N	N/A	Ready to ship. Geometry on flasher.

F: All data transfers, including battery charge status, together with the employees performing the work are documented in a single printout.

G: During software operation, the user can send a copy to colleagues for information or checking.

H: At the time of each data reconciliation, the reason for the data transfer must be entered with details of tool condition.

Installation of the BRW 841130 in the parting plane

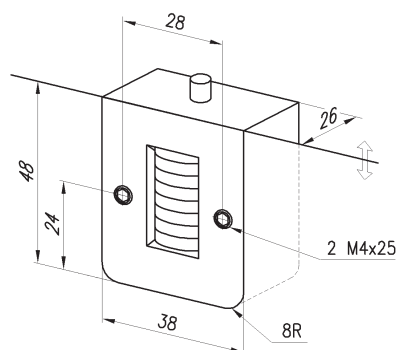

Please note:

Injection moulding tools with the BRW 841140 cycle counter can be upgraded with the BRW 841130 digital counter since the dimensions are identical.